

# AVAILABLE

## NUTWOOD INDUSTRIAL PARK

NOW AVAILABLE: 1,000 SF TO 3,500 SF



### FEATURES:

- Ground Level Loading Door (10' x 10')
- Excellent Truck Access
- 12' to 16' Warehouse Clearance Height
- Yard Available
- East 22 Fwy Access
- Low Gross Rates

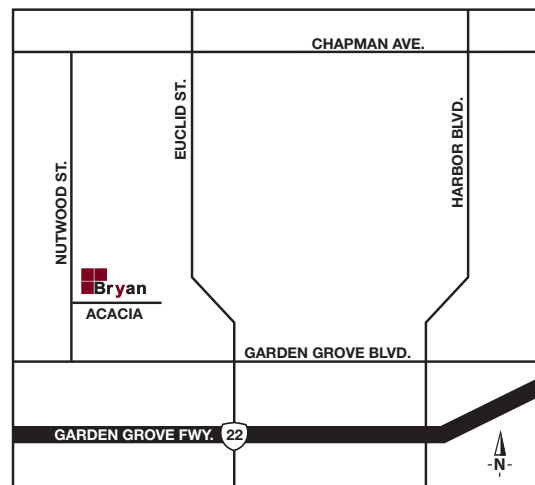

146 E. Orangethorpe Ave. • Anaheim, CA 92801  
Phone: (714) 871-1314 • Fax: (714) 680-3727  
www.bryanindprop.com  
DRE #0002442

For more information, please contact:

**John Maresca**  
DRE #00896979  
(714) 871-1314  
john@bryanindprop.com

## COMPETITIVE LEASE TERMS CALL TO TOUR ■ NO CAM'S

The information contained herein has been obtained from sources we deem reliable. However, no warranties or representations, expressed or implied, are made as to the accuracy of any information contained herein, and the information is subject to errors and omissions. This information is also subject to price, rental or other conditions, withdrawal without notice, and to any special listing conditions imposed by our principals.

**NUTWOOD INDUSTRIAL PARK  
GARDEN GROVE  
1,000 SF TO 3,500 SF**

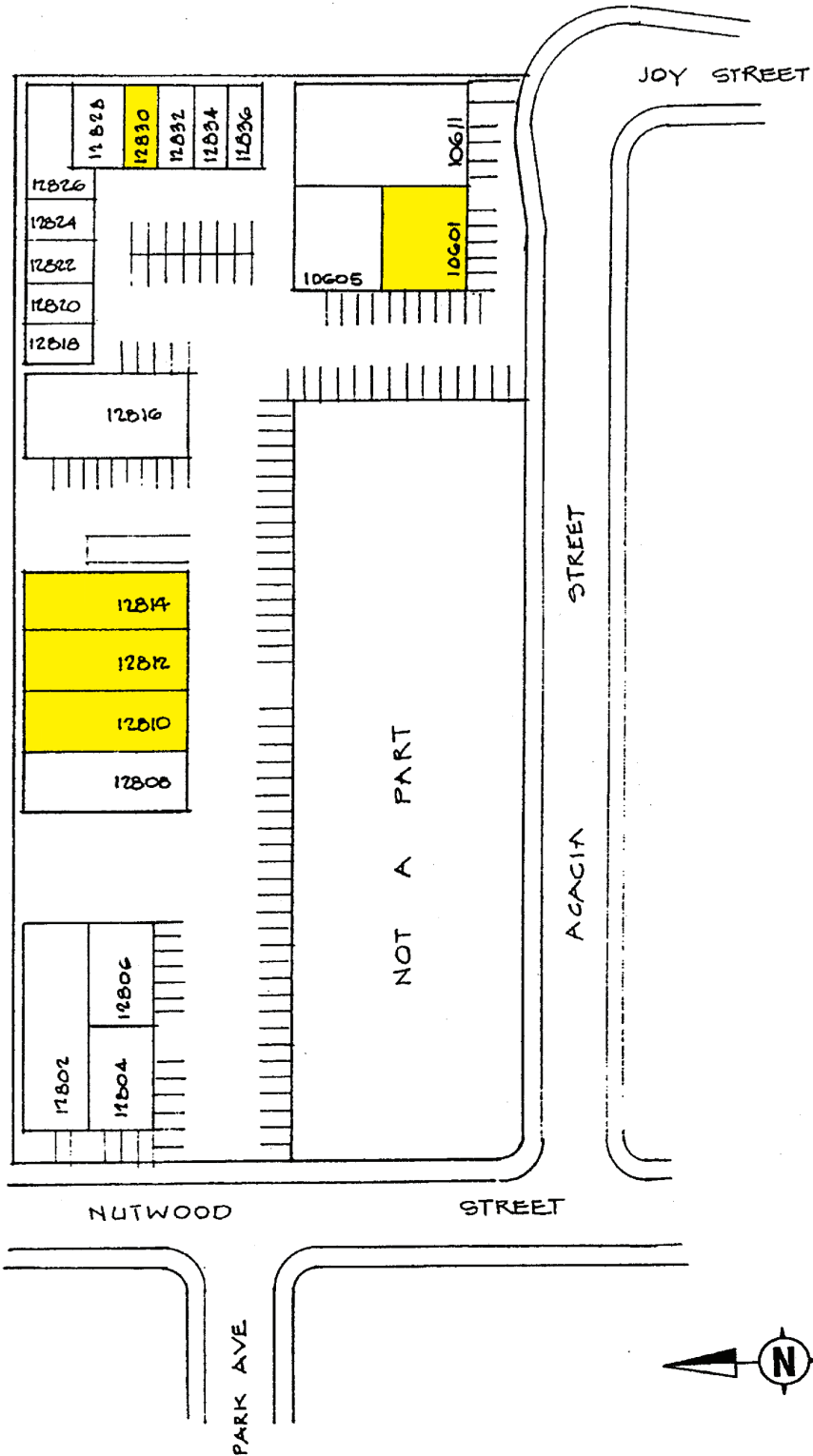

For reference purposes only . . . not to scale.